



YAMAHA

**03-06 400/450 KODIAK 4X4,
04-06 350 BRUIN, 07 450 Grizzly
07 350 Grizzly 2x4 & 4x4**

WINCH MOUNTING INSTRUCTIONS

Qty.	Part #	Description
1	1566-1	Winch Mount
1	1566-2	Roller Fairlead Mount Plate
1	1600W	Roller Fairlead
8	HDW2050	5/16" x 3/4" Hex Bolts
4	HDW9034	5/16" x 1-1/4" Fender Washers
8	HDW7058	5/16" Nylock Nuts

**CUSTOMER MUST RECEIVE A COPY
OF THIS INSTRUCTION SHEET AT
THE TIME OF SALE**

P/N: 4505-0187

1. Temporarily remove (2) 6mm skid plate bolts and the front bumper.
2. Install the roller fairlead mount plate to the winch mount plate using (2) of the provided 5/16" x 3/4" hex bolts per the illustration.
3. Install the winch mount to the bumper using the (4) provided bolts, fender washers and nylock nuts. Pull the winch mount all the way forward and tighten firmly.
4. Install the roller fairlead to the winch mount using the (2) 5/16" x 3/4" hex bolts and (2) 5/16" Nylock nuts provided with the fairlead and tighten. (Rollers should turn freely.)
Note: Bottom roller may need to be removed to run wire rope through.
5. Install the winch on top of the winch mount using the hardware provided with the winch.
6. Using the instructions provided with the winch, wire accordingly.
7. Re-install the bumper and skid plate using the bolts previously removed.

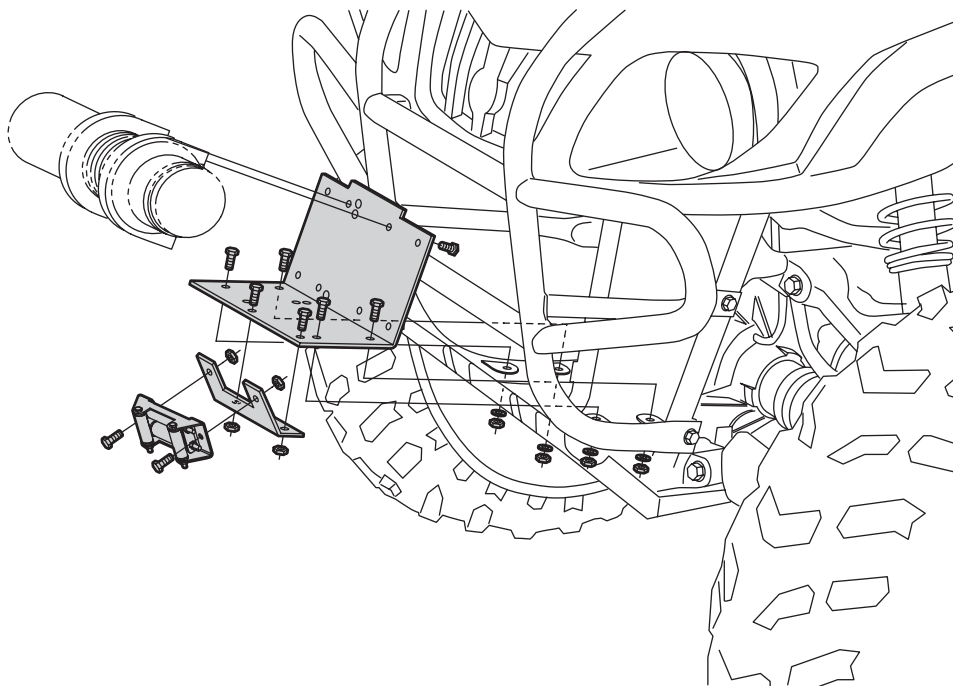

For questions regarding the installation of this mount please call: 763-689-4800